



23 Cover Drive

Darfield, Barnsley, S73 9HE

£125,000



Offered to the market with IMMEDIATE VACANT POSSESSION AND NO VENDOR CHAIN is this well proportioned two bedroom semi detached bungalow, situated in the popular village of Darfield. The property benefits from gas central heating, double glazing, a conservatory and gardens to the front and rear. CALL TODAY TO BOOK YOUR VIEWING !



GROUND FLOOR

Entrance Hall

Lounge

Having a front facing double glazed window, feature fire with surround, tv aerial point and radiator.

Dining Kitchen

Comprising a range of wall and base units, worktop surface which incorporates the sink unit with mixer tap, space for a cooker, under counter fridge freezer and plumbing for a washing machine. Rear facing double glazed window and radiator.

Conservatory

Overlooking the rear garen.

Bedroom One

A double bedroom having a double glazed window and radiator.

Bedroom Two

Having a double glazed window and radiator.

Bathroom

A three piece suite.

OUTSIDE

There is gardens front and rear and to the side provides off road parking.

Area Map



Floor Plans

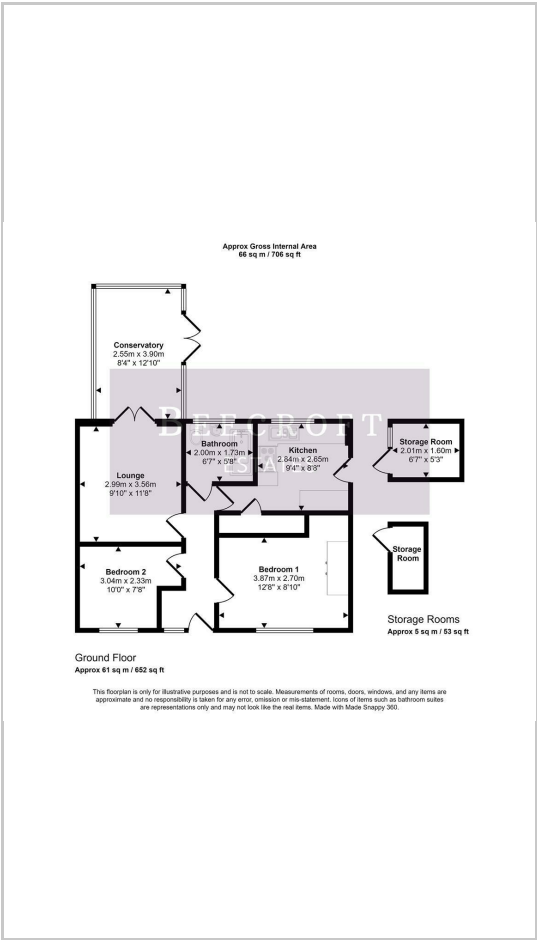

Energy Efficiency Graph

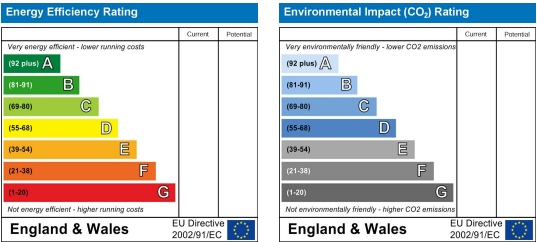

These particulars, whilst believed to be accurate are set out as a general outline only for guidance and do not constitute any part of an offer or contract. Intending purchasers should not rely on them as statements of representation of fact, but must satisfy themselves by inspection or otherwise as to their accuracy. No person in this firms employment has the authority to make or give any representation or warranty in respect of the property.